

**COLLEGE OF INDUSTRIAL ARTS
STATE COLLEGE FOR GIRLS**

NOTE: EXTERIOR NUMBERS ON DOOR-PL. SYSTEMS, SEWER, Y-PIPING EXCEPT AS NOTED. ALL BUILDINGS HAVE STEAM HEAT. LIGHTS ELECTRIC. FUEL COAL. CITY WATER-1 P.S. & USE REG. 60-GRAND.

SCALE 100 FT TO AN INCH

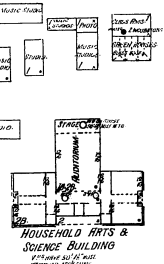
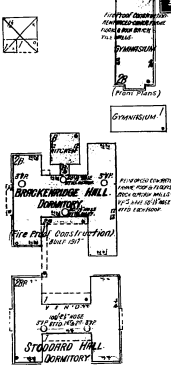
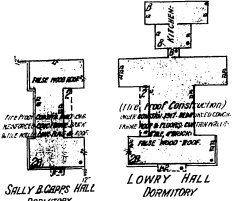
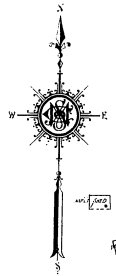

ADMINISTRATION BUILDING.
SHELLS AND PARTS FRIGID IN EXTERIOR.
FIRST FLOOR FRIGID AND SECOND FLOOR
FRIGID CONCRETE CONCRETE, ASP. & FLOORING
FRIGID IN WALLS. CONCRETE CONCRETE
LIVING PART AND CONCRETE & FLOORING
CONCRETE CONCRETE CONCRETE & FLOORING
FRIGID CONSTRUCTION. FLOORING FRIGID
FRIGID & FLOORING FRIGID & FLOORING
FRIGID FLOOR

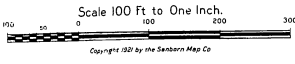

16